

How can I best use the TEAL spaces?

INSPIRING PEOPLE

Overview

About you
The evidence
Teaching and learning possibilities
Practical considerations
How might you use the space?



Introductions

Name
Subject/School
Did you choose to use a TEAL space?

Are you... (choose as many as apply)

- 1) Excited to use a TEAL space
- 2) Nervous to use a TEAL space
- 3) Planning new ways of teaching
- 4) Planning to teach how I always do
- 5) Other – please specify

The evidence

- * **Active learning enhances learning** (reduces misconceptions, leads to deeper learning) (Chickering & Gamson 1986; Gibbs 2010; Michael 2006)
- * **Interaction between staff and students enhances learning and student satisfaction** (Bligh 1972; Huxham 2005; Kuh & Hu 2001)
- * **Smaller classes – ideas exploration > fact clarification** (Cuseo 2007; Gibbs 2012)
- * **Active learning spaces enhance GPAs** (Chiu & Cheng 2016)



Teaching and Learning Possibilities

1. Use the technology & small groups
2. Use the small group set up
3. Use other technologies

Moving to student-centred learning

- Jigsaw classroom
- Doughnut rounds
- Pair, group, class activities
- Flipped classroom
- Presentation/assignment preparation



Youtube clips about active learning spaces
<https://www.youtube.com/watch?v=0tMc0JY0978>

https://www.youtube.com/watch?v=iFT_hoiuY8w
<https://www.youtube.com/watch?v=H7xidmV10uE>
<https://www.youtube.com/watch?v=H7xidmV10uE>
<https://www.youtube.com/watch?v=BSmoezXh28E>
<https://www.youtube.com/watch?v=V-U83Zz8D0>

Find resources relevant to an area of learning -
Example of a possible use of TEAL spaces

Practicalities

- Inform students if you wish them to bring laptops or tablets to class
- Have a plan B in case things don't go as you expect them to
- Think about co-teaching, seeking GTA/demonstrator support

Using TEAL spaces

How are you thinking of using the TEAL space?

Do you have any concerns?

What further support do you think you need?

Reflections on using AL spaces

"My personal view is that we often under-estimate the power of simply being in a well-designed space which makes even quite standard activities, such as collaborative group problem-solving sessions, both easier to implement and just more enjoyable for students and staff alike. The technology, although useful on occasion, is probably secondary to the layout, footprint etc. In fact, some of our more recent Teaching Studios have less advanced technology than the earlier rooms and this hasn't detracted from their usefulness."

(University of Edinburgh Professor)

TEAL Moodle area

Slides

We would like to hear your feedback

Further resources

<http://moodle2.gla.ac.uk/course/view.php?id=9933>

Contact us at the Learning and Teaching Centre

Catherine.bovill@glasgow.ac.uk
 Craig.brown@glasgow.ac.uk
 Vicki.dale@glasgow.ac.uk
 Angela.jaap@glasgow.ac.uk
 Amanda.sykes@glasgow.ac.uk

References

Bligh, D.A. (1972) *What's the use of lectures?* Harmondsworth, Penguin.

Chickering, A.W. and Gamson, Z.F. (1987) Seven principles for good practice in undergraduate education. *AAHE Bulletin* March, pp3-7. <http://eric.ed.gov/?id=EJ028249>

Chiu, P.H.P. and Cheng, S.H. (2016) Effects of active learning classrooms on student learning: a two-year empirical investigation on student perceptions and academic performance. *Higher Education Research and Development Online* first. <http://www.tandfonline.com/doi/full/10.1080/07294360.2016.1196475?scroll=top&needAccess=true>

Cuseo, J. (2007) The empirical case against large class size: adverse effects on the teaching, learning and retention of first-year students. *The Journal of Faculty Development* 21 (1) 5-21.

Gibbs, G. (2010) *Dimensions of Quality*. York: Higher Education Academy. https://www.heacademy.ac.uk/sites/default/files/dimensions_of_quality.pdf

Huxham, M. (2005) Learning in lectures. Do interactive windows help? *Active Learning in Higher Education* 6 (1) 17-31.

Kuh, G. & Hu, S. (2001) The effects of student-faculty interaction in the 1990s. *The Review of Higher Education* 24 (3) 309-332.

Michael, J. (2006) Where's the evidence that active learning works? *Advanced Physiology Education* 30 159-167.

TEAL: St Andrews Building 202 (30)

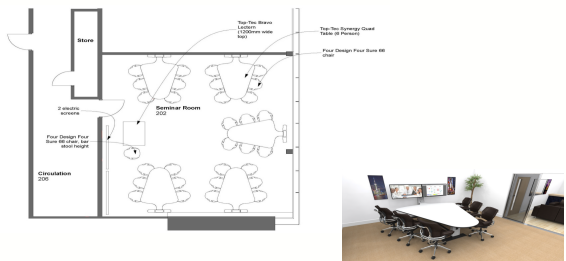

TEAL: Wolfson Medical School – Hugh Fraser (60)

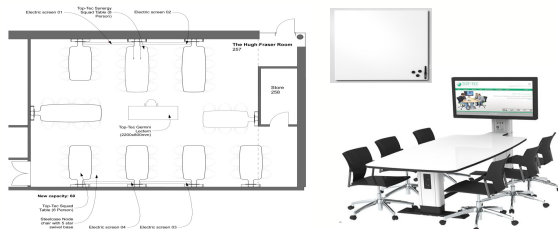

Adam Smith 901-904 (15)

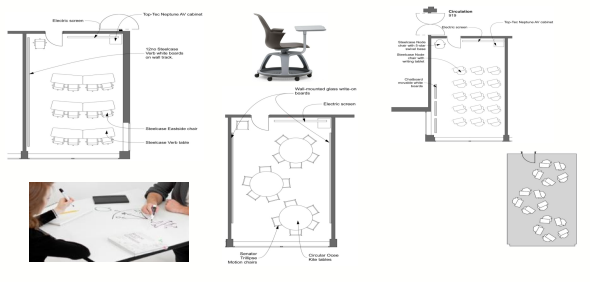

Lecture/Seminar Rooms

St Andrews 227 (30)

Wolfson Gannochy (60)

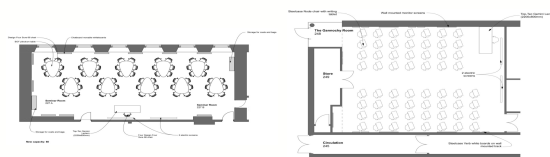

Learning Spaces Working Group

Moira Fischbacher-Smith (Social Sciences)
 Brian Husband (AV-IT)
 Karen Lee (Timetabling)
 Eleanor Magennis (Estates & Buildings)
 Kevin O'Dell (MVLS)
 Don Spaeth (Arts)
 Matthew Williamson (L&TC)

Please send comments and questions to any of us

Details of layout and features of rooms:

<http://www.gla.ac.uk/services/estates/timetabling/>

LT Hub video:

<http://media.gla.ac.uk/web/news/campusnews/learningandteachinghub.mp4>